

Model #: TN7122
(2 Drawer, No Laminated Top)

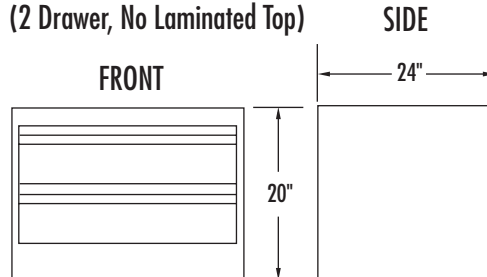

Model #: TN7139 (3 Drawer)

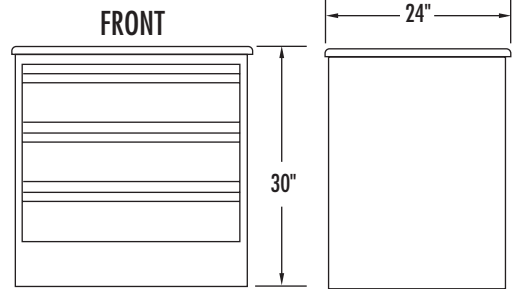

Model #: TN7159 (5 Drawer)

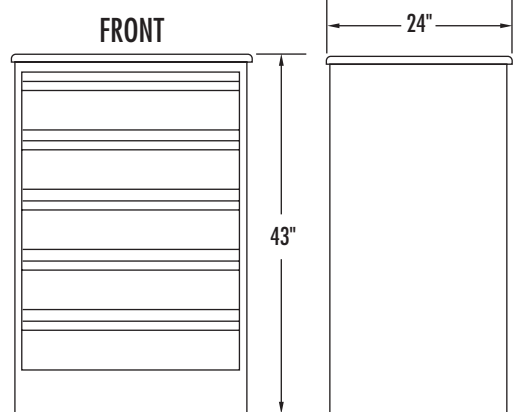

TOP (TN7122)

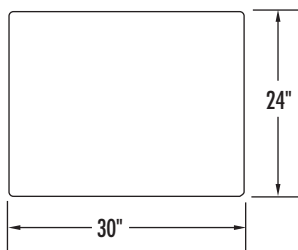

TOP (TN7139 & TN7159)

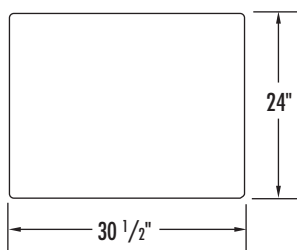

Overview

Steel chests with non-removable drawers. Engineered and proven suitable for continuous use in an institutional environment. Three and Five drawer models feature wood-grained thermolaminate top and drawers with padlock hasp locking mechanism. Drawer glides are welded to drawer body, with no moving parts.

Fabrication & Material:

Cut, formed, welded and ground smooth steel.
Cabinet body: 20 gauge steel.
Drawers: 20 gauge steel.
Drawer and Slides: 14 gauge steel.
Slide supports: 20 gauge steel.
Top and bottom rail: 18 gauge steel.
Thermolaminate top: (TN7139 & TN7159) .75" medium density fiberboard (MDF) core, with decorative rigid thermofoil (RTF) laminate top surface. Rounded edge for added safety.

Finish:

Cabinet: Powder coated steel.
Top: Wood grain thermolaminate (TN7139 and TN7159 only).

Color:

Steel: Khaki.
Wood Laminate: Hayward Cherry

Options:

Padlock hasp mechanism (2 Drawer - TN7122).

Weight:

TN7122: 97 lbs.
TN7139: 111 lbs.
TN7159: 145 lbs.

Assembly:

Shipped assembled.

Installation:

None required.

Warranty:

10 year limited replacement warranty.

Maintenance:

Easily cleaned with a damp cloth and a mild soap solution.

Filing System:

12600 Institutional Furniture
11197 Correctional Furniture