

Assembly Notes: Norix is not responsible for any damage due to improper installation. If your shipment does not match the parts list, please contact Norix Customer Service at 800-234-4900. Norix reserves the right to modify design specifications at any time without an obligation to owners of previously sold products.

PARTS LIST

| ITEM | QTY | PART NUMBER | DESCRIPTION |
|------|-----|-------------|--|
| 1 | 1 | 050-0201 | Sierra FS End Table Top - 24" x 24" |
| 2 | 2 | 001-245 | Sierra Table Bracket |
| 3 | 10 | 021-010 | Socket Cap Screw, 3/8-16 x 1", Black Oxide |
| 4 | 10 | 025-003 | Lock Washer, 3/8 Black Oxide |
| 5 | 10 | 025-002 | Fender Washer, 3/8 Black Oxide |

Tools Needed

Low RPM Variable Speed Drill

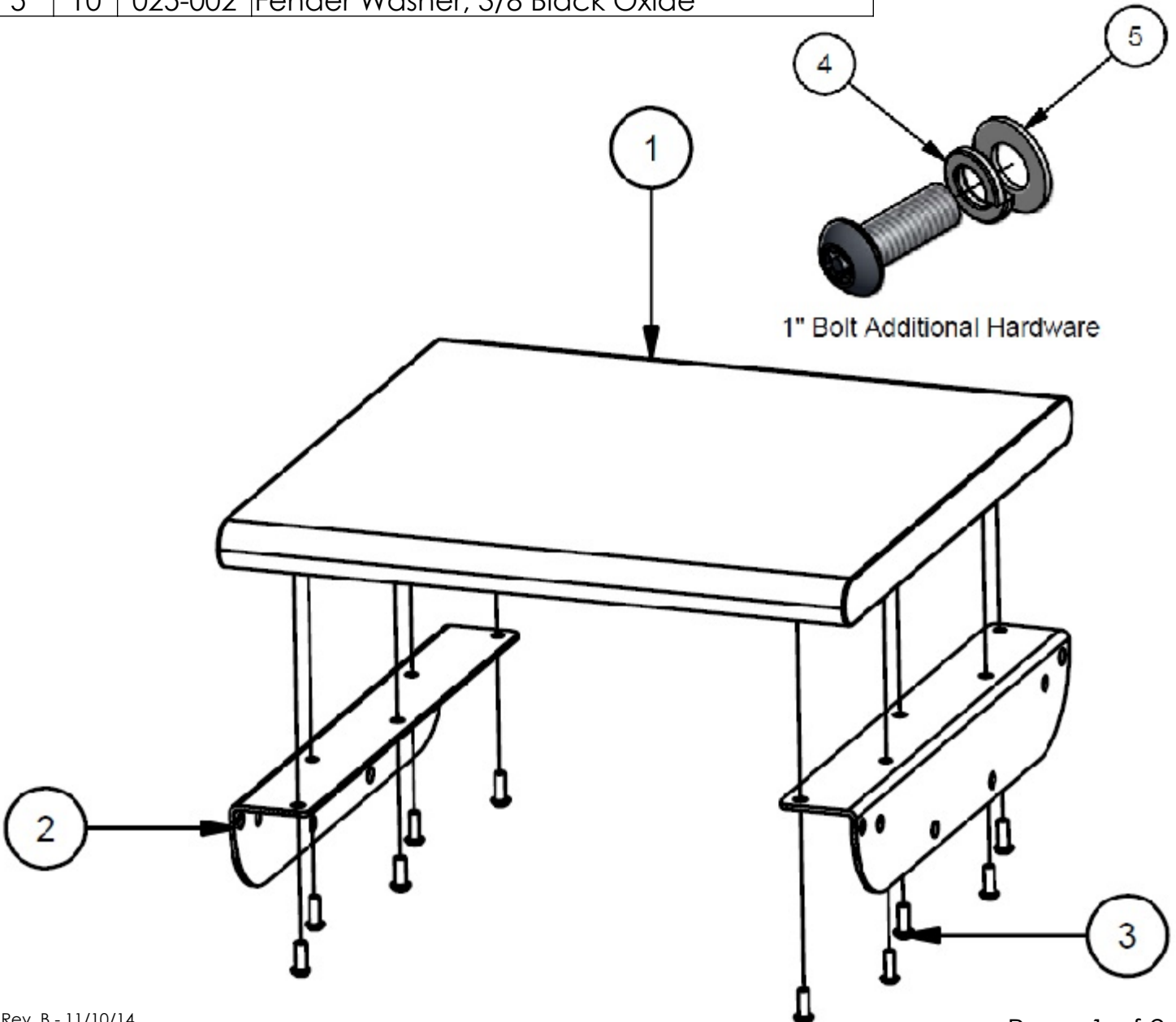

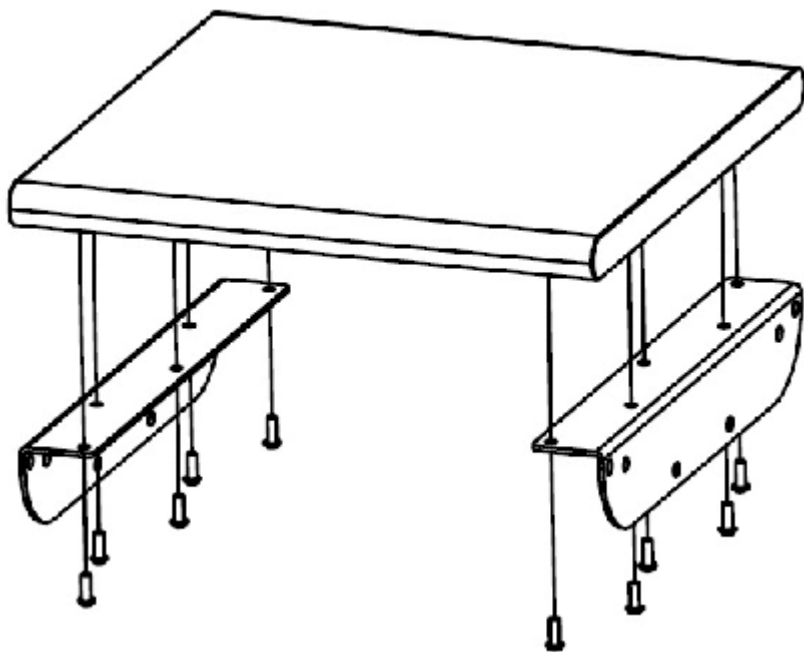

Step 1

Secure (2) Table Brackets to Table Top using (10) 3/8 x 1" Screws.

Step 2

Position Sierra seating unit. Secure Bracket to outside of Right Arm using (3) 1/2" x 3" Screws from Sierra seating unit.

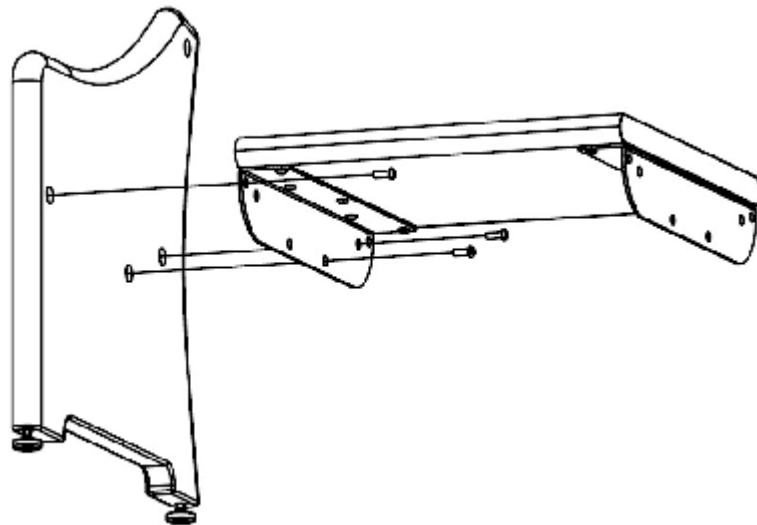

Step 3

Position adjacent Sierra seating unit. Secure Bracket to outside of Left Arm using (3) 1/2" x 3" Screws from Sierra seating unit.

